

ABERNATHY and ASSOCIATES

Kenneth B. Abernathy Jr.

Wisconsin Registered Land Surveyor S-1594

W4056 Bray Road 53121
Elkhorn, Wisconsin
Phone: (414) 723-4260 (office)
(414) 723-4813 (residence)

PLAT OF SURVEY

Lot 5 of Fairbluff Estates Addition Number 1
Subdivision, located in the Southeast 1/4 of the
Southwest 1/4 and the Southwest 1/4 of the
Southeast 1/4 of Section 5, Town 4 North,
Range 16 East, Town of La Grange, County of
Walworth, State of Wisconsin.

Knuteson
Drive

Lot 4

INGRESS AND EGRESS EASEMENT

Lot 5

2.1 Acres ±

Lot 6

Owner: Gerald Knuteson
245 North Esterly Street
Whitewater, Wisconsin 53190

HFAI-5

NOTE
WOOD STAKES HAVE BEEN PLACED AT BUILDING CORNERS,
BUILDER IS TO VERIFY DIMENSIONS WHICH HAVE BEEN
ROUNDED TO THE NEAREST TENTH OF A FOOT TO INSURE
PROPER PLAN INTERPRETATION AND CONTACT THIS OFFICE
IMMEDIATELY IF ANY DISCREPANCY EXISTS.

Legend

- FOUND IRON PIPE
- FOUND IRON ROD
- FOUND BRASS CAPPED MONUMENT
- FOUND CONCRETE MONUMENT
- CHISEL CUT IN CONCRETE
- SET IRON ROD, 24" LONG, WEIGHING 1.5 LBS./LINEAL FT., 3/4" DIA.
- SET IRON ROD, 36" LONG, WEIGHING 4.5 LBS./LINEAL FT., 1-1/16" DIA.
- RECORDED AS DIMENSION
- EXISTING FENCE

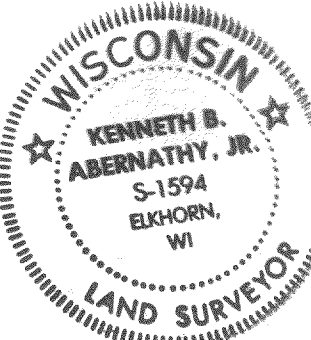
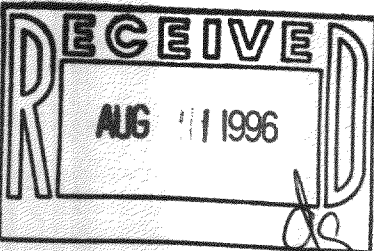

"I hereby certify that the above described property has been surveyed
by me or under my direction and that the above map is a true
representation thereof and shows the size and location of the property,
its exterior boundaries, the location of all visible structures and
easements, roadways and visible encroachments, if any."
"This survey is made for the use of the present owners of the property
and also those who purchase, mortgage, or guarantee the title thereof
within one year from date hereof."

KENNETH B. ABERNATHY, JR.
WISCONSIN REGISTERED LAND SURVEYOR
S-1594

Date: July 23, 1996 Job No. 1996.604

416-1225